

31 VENTURES

Venture Co-creation by Mitsui Fudosan

— Supporting your business to cater to the growth stage —

Management
support
and advice

Exploring sales
channels
and introducing
partners

Providing
implementation
fields

Financing
and business
collaboration

On April 1, 2015, Mitsui Fudosan launched the 31VENTURES, a full-fledged venture co-creation project to work closely with startups on “co-creating” businesses. At Venture Offices, a part of the project, we provide all of the equipment and facilities to allow you to move in and start business immediately, as well as flexible operations to meet the needs of venture businesses. We also offer space and communities to foster business growth and innovation, including a wide range of networks, new inspiration and supportive advisers. Moreover, customers who move to the 31VENTURES Floor can use the business support service through 31VENTURES by Mitsui Fudosan.

LINK-J connects people and ideas for those involved in the life sciences.

LINK-J is a platform for creating new life-science industries with the four functions of “bring together” , “connect” , “grow” and “take off” . LINK-J brings together a wide range of parties in the life sciences field. Creating new ideas, connecting people, and accelerating new initiatives. Providing an ecosystem to support open innovation.

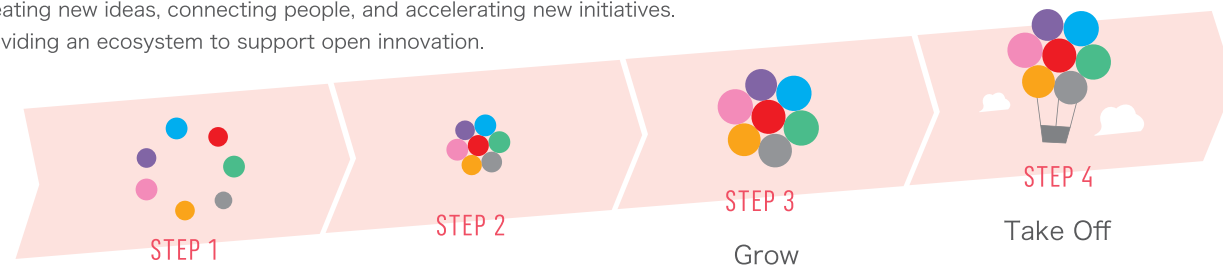

Bring Together

LINK-J hosts symposia, seminars, and other gatherings that focus on specific themes within the many interdisciplinary life science fields. We also actively support similar events organized by external organizations.

Connect

LINK-J collaborate with overseas organizations. In addition, at our base in Nihonbashi, we provide spaces – from communication lounges to conference rooms – where members can engage in comprehensive dialogue.

Grow

LINK-J supports communication and growth by providing spaces that allow diverse perspectives to be brought to the table and by offering acceleration programs as well as study sessions where specific topics are discussed in depth.

Take Off

LINK-J hosts partnering events and venture pitches which aims to procure funds from angel investors and venture capitalists and to foster alliances between operating companies and startups.

Access

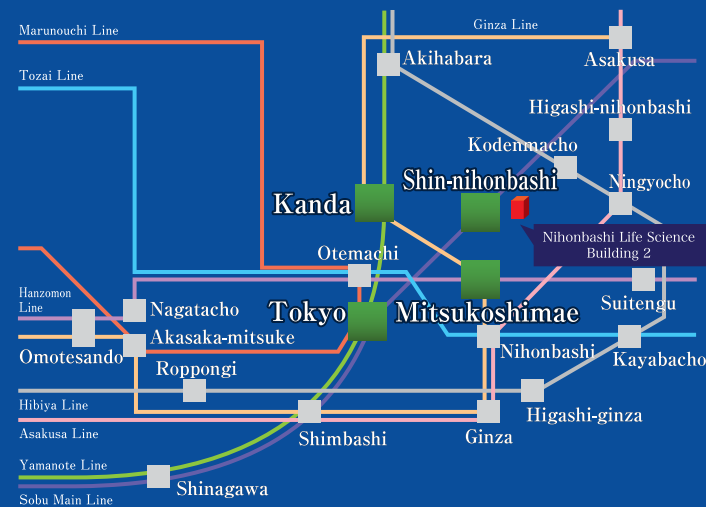

- Tokyo Metro Hibiya Line 3 minute walk from Kodenmacho Station
- JR Sobu Line 3 minute walk from Shin-Nihombashi Station
- Tokyo Metro Ginza Line /Hanzomon Line 5 minute walk from Exit #A9 of Mitsukoshimae Station



3-11-5, Nihonbashi Honcho, Chuo-ku, Tokyo, 103-0023

For inquiries about moving-in For inquiries about joining LINK-J

Tel : 03-3516-2735
(Mitsui Fudosan)

Tel : 03-3241-4911
(LINK-J)

Nihonbashi Life Science Building 2 31VENTURES Floor

Nihonbashi
Life Science Building 2
31VENTURES Floor

Nihonbashi
Life science
Building 2
31VENTURES
Floor

Offices for venture businesses equipped with facilities
and the essential environment for fostering
business growth and innovation

Fully equipped
common space
exclusively for
LINK-Jmembers
in the Nihonbashi
Life Science Building



Located in Nihonbashi-honcho, Chuo-ku.
The building has dignified appearance
and entrance hall.



Conference rooms are available for meetings
and seminars at a LINK-J member's price.

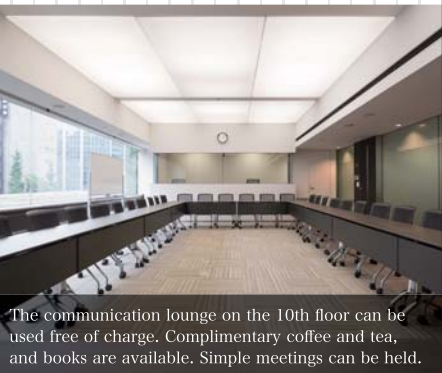

The communication lounge on the 10th floor can be
used free of charge. Complimentary coffee and tea,
and books are available. Simple meetings can be held.

Floor Layout Floor Layout (For reference. *Tables and chairs will not be set.)

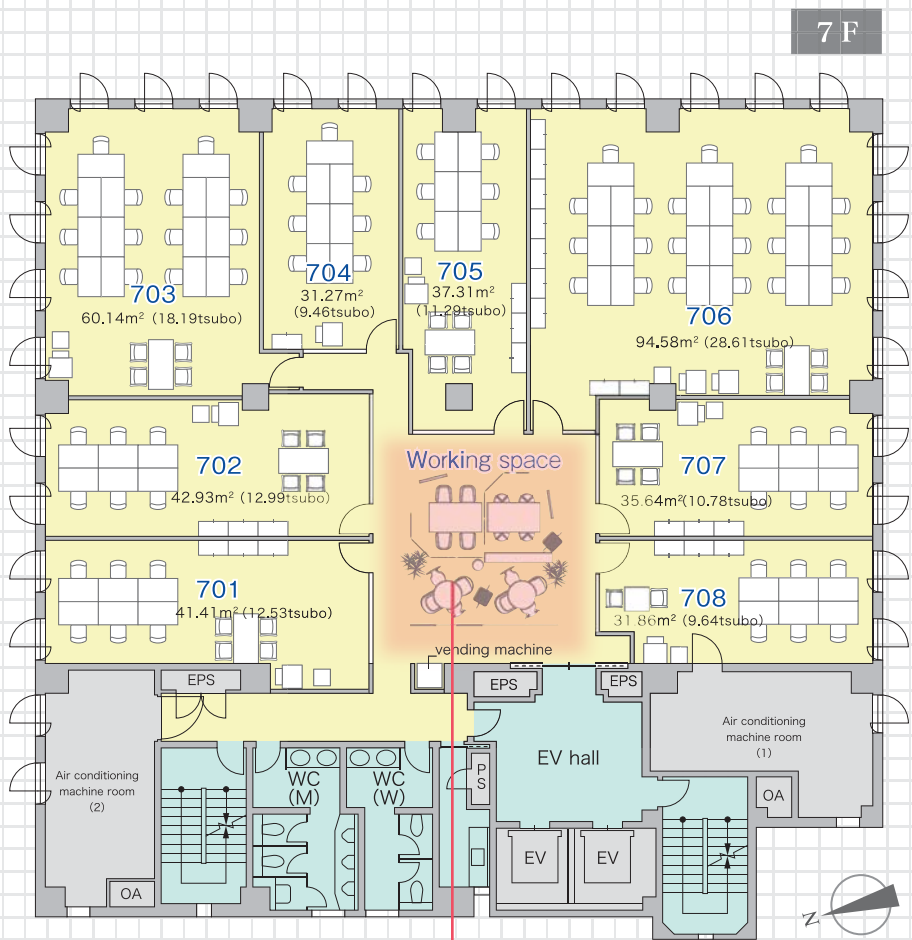
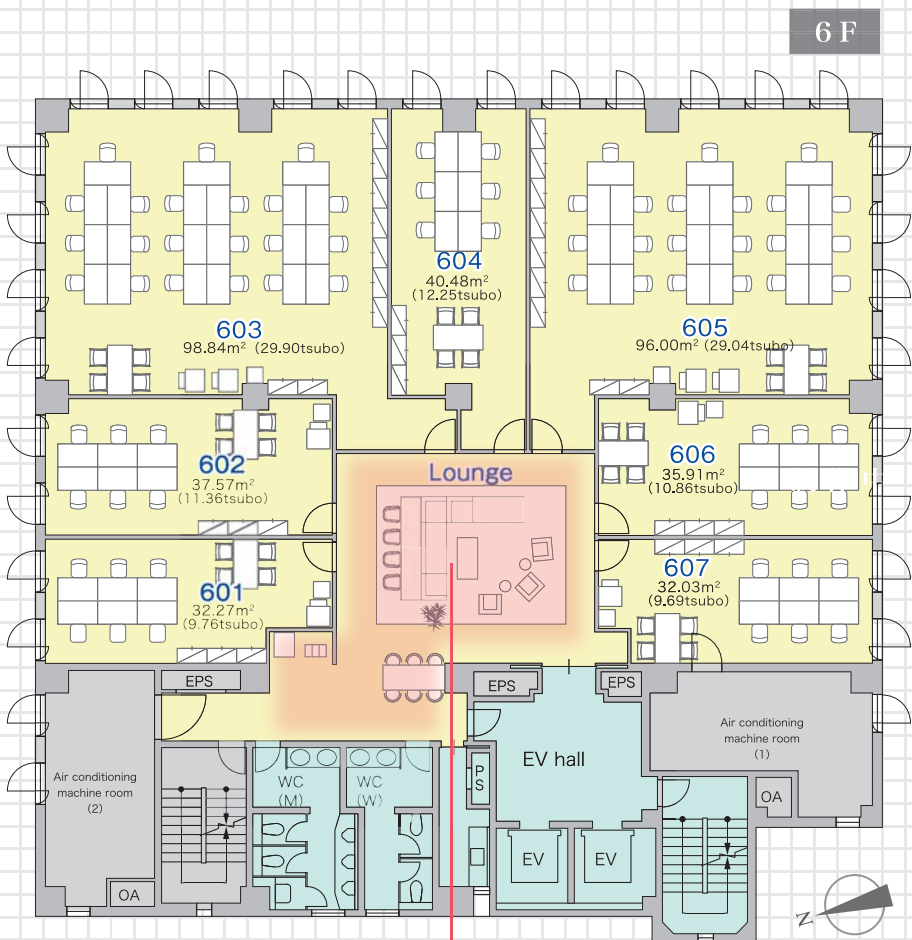
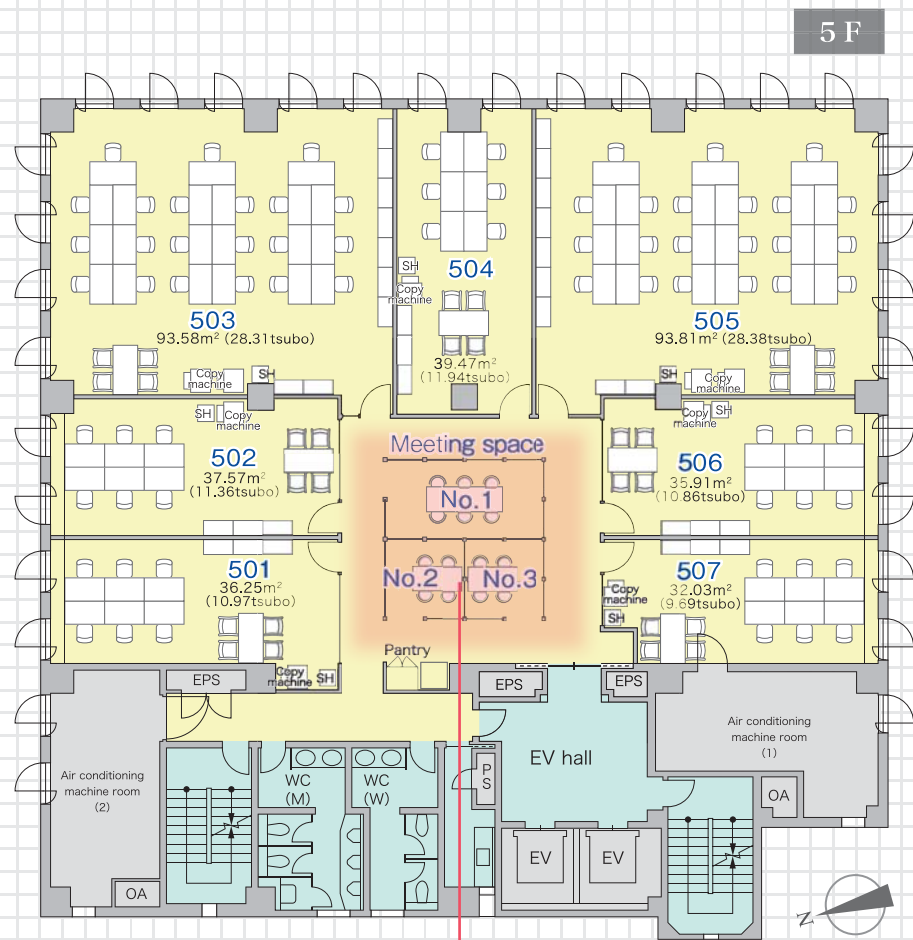

Tenants on the 5th, 6th and 7th floors can freely use the common space on each floor.

Office
space

A variety of spaces are available,
from approximately 32 m²
(10tsubo) to 94 m² (30tsubo).



94 m² (30tsubo)



32 m² (10tsubo)

Security

The security system is in place to
control floor entry. You will feel
safe and secure (5th and 7th floors only).



Pantry

A coffee machine is available.



Meeting
space

The meeting space can be used
when customers visit.



Lounge

The lounge can be used when
customers visit.



Screening is required
prior to move-in.
Joining LINK-J is also required.

LINK-J Special Members B* (Excluding tax)	Enrollment fee	30,000 yen
	Annual fee	120,000 yen

*(i) Corporations with 100 or fewer employees and in business for fewer than 20 years (ii) Non-profit organizations (Independent administrative agency, national research and development agency, administrative agencies, educational corporations, general corporations, public benefit corporations, social welfare corporations, quasi-public bodies of diplomatic missions in Japan and other such institutions)

Profile of the property		Profile of equipment	
Name	Nihonbashi Life Science Building 2	Air conditioning	Two systems on each floor, humidifying air conditioning
Address	3-11-5, Nihonbashi Honcho, Chuo-ku, Tokyo	Ceiling height	2,470mm
Transportation	3 minutes' walk from JR Line Shin-Nihonbashi Station	Equipment	Security system installed
	3 minutes' walk from Hibiya Line Kodenmacho Station	Elevators	2 units
	5 minutes' walk from Hanzomon Line and Ginza Line Mitsukoshimae Station	Floor finish	OA floor (50 mm)
Site area	983.50 m ² (297.50 tsubo)	Electrical capacity	200A
Structure scale	Steel reinforced concrete construction, 9 storey, one basement level	Entrance opening hours	South: 8:00-18:30 North: 6:30-20:00
Completion	September 1987		