

# TOKYO

## Nihonbashi

### Nihonbashi Life Science Building

2-3-11, Nihonbashi-honcho, Chuo-ku, Tokyo, 103-0023

Tokyo Metro Ginza and Hanzomon Lines

3 min. walk from Mitsukoshimae Sta. [Exit A6]

JR Sobu Rapid Line

2 min. walk from Shin-Nihonbashi Sta. [Exit 5]

JR Yamanote, Keihin-Tohoku, and Chuo Rapid Lines

11 min. walk from Kanda Sta. [South Exit]

JR Yamanote, Keihin-Tohoku, and Chuo Rapid Lines

13 min. walk from Tokyo Sta. [Nihonbashi Exit]

### Nihonbashi Life Science HUB

1-5-5, Nihonbashi-muromachi, Chuo-ku, Tokyo, 103-0022

8F Muromachi Chibagin Mitsui Building

Tokyo Metro Ginza and Hanzomon Lines

Directly connected to Mitsukoshimae Sta.

JR Sobu Rapid Line

Directly connected to Shin-Nihonbashi Sta.

JR Yamanote, Keihin-Tohoku, and Chuo Rapid Lines

9 min. walk from Tokyo Sta. [Nihonbashi Exit]

### Nihonbashi Life Science Building 2

3-11-5, Nihonbashi-honcho, Chuo-ku, Tokyo, 103-0023

JR Sobu Rapid Line

3 min. walk from Shin-Nihonbashi Sta. [Exit 5]

Tokyo Metro Hanzomon and Ginza Lines

5 min. walk from Mitsukoshimae Sta. [Exit A10]

Tokyo Metro Hibiya Line

3 min. walk from Kodenmacho Sta. [Exit 3]

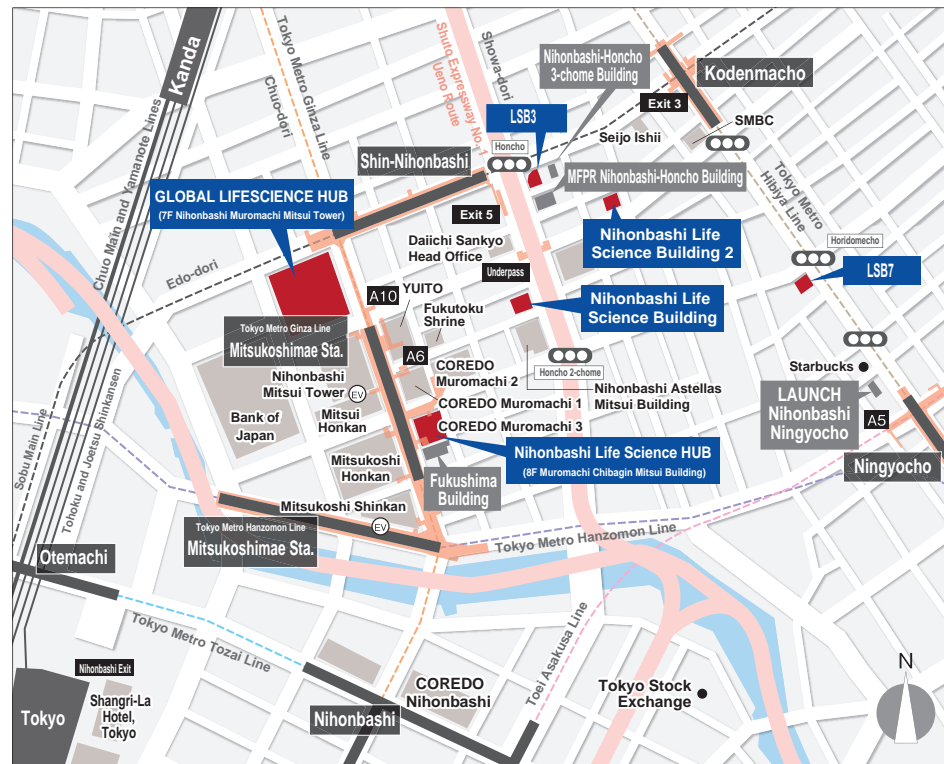

### Nihonbashi Life Science Building 3

3-8-3, Nihonbashi-honcho, Chuo-ku, Tokyo, 103-0023

JR Sobu Rapid Line

1 min. walk from Shin-Nihonbashi Sta. [Exit 5]

Tokyo Metro Hibiya Line

3 min. walk from Kodenmacho Sta. [Exit 3]

Tokyo Metro Ginza and Hanzomon Lines

5 min. walk from Mitsukoshimae Sta. [Exit A10]

### Nihonbashi Life Science Building 7

1-9-10, Nihonbashi-horidomecho, Chuo-ku, Tokyo 103-0012

Tokyo Metro Hibiya Line

4 min. walk from Ningyocho Sta. [Exit A5]

Tokyo Metro Hibiya Line

5 min. walk from Kodenmacho Sta. [Exit 3]

### GLOBAL LIFESCIENCE HUB

3-2-1, Nihonbashi-muromachi, Chuo-ku, Tokyo, 103-0022

7F Nihonbashi Muromachi Mitsui Tower

Tokyo Metro Ginza and Hanzomon Lines

Directly connected to Mitsukoshimae Sta.

JR Sobu Rapid Line

Directly connected to Shin-Nihonbashi Sta.

## Life Science Building Series



## Communication Lounge & Conference Room



# OSAKA

## Hommachi

### Lifescience HUB West

4-1-3, Bingomachi, Chuo-ku, Osaka-shi, Osaka 541-0051

4F Midosuji Mitsui Building

Osaka Metro Midosuji, Chuo and Yotsubashi Lines

1 min. walk from Hommachi Sta. [Exit 2]

Keihan Electric Railway

10 min. walk from Yodoyabashi Sta. [Exit 12]





# Communication Lounge

Communication lounges are spaces that LINK-J members can use casually to interact and communicate with each other. These members-only areas are stocked with books relating to life sciences, as well as a selection of drinks and snacks.\* Please make use of these lounges as a third place for communication between members.

\* Some snacks must be purchased.

## Nihonbashi Life Science Building

2-3-11, Nihonbashi-honcho, Chuo-ku, Tokyo

The Nihonbashi Life Science Building has two open-plan communication lounges; one located at the 1st floor entrance and the other on the 10th floor. The 10F lounge can also be reserved and used exclusively, for social gatherings and parties.



Appearance

**1F** 66.4 m<sup>2</sup> (about 20.08 tsubo)

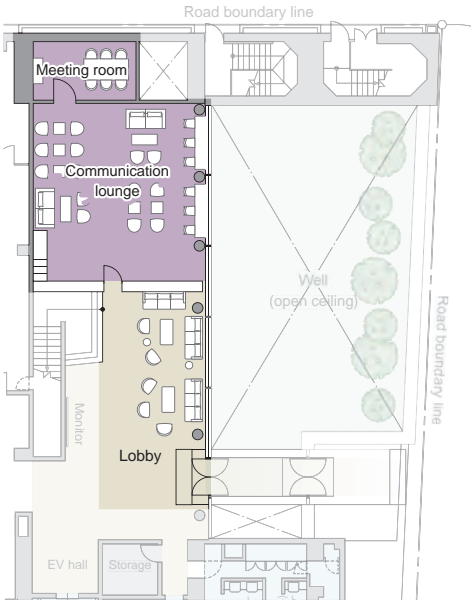

The communication lounge with an open ceiling and relaxing lobby



Communication lounge (1F)

**10F** 191.18 m<sup>2</sup> (about 57.82 tsubo)

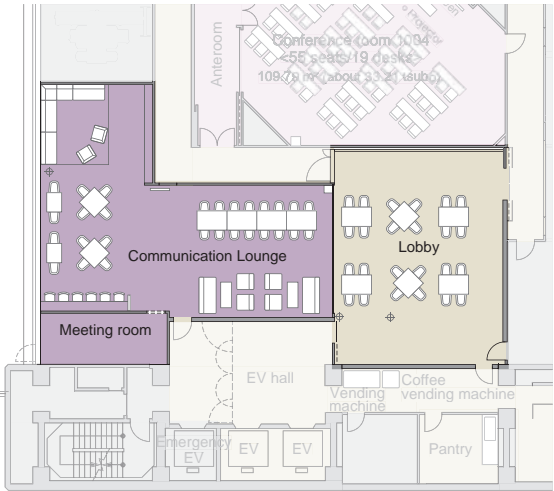

The lounge can be used as a place of exchange with LINK-J members and as an individual workplace. It can also be used exclusively, for social gatherings or parties using the catering service.



Communication lounge (10F)

## Nihonbashi Life Science HUB

8F Muromachi Chibagin Mitsui Building 1-5-5, Nihonbashi-muromachi, Chuo-ku, Tokyo

The Communication Lounge is adjacent to the conference room, which has a maximum capacity of 300 persons. The lounge can be reserved and used exclusively, such as for social gatherings and parties after conferences.

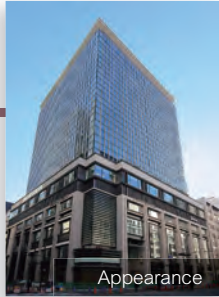

Appearance

**8F** 153.40 m<sup>2</sup> (about 46.40 tsubo)

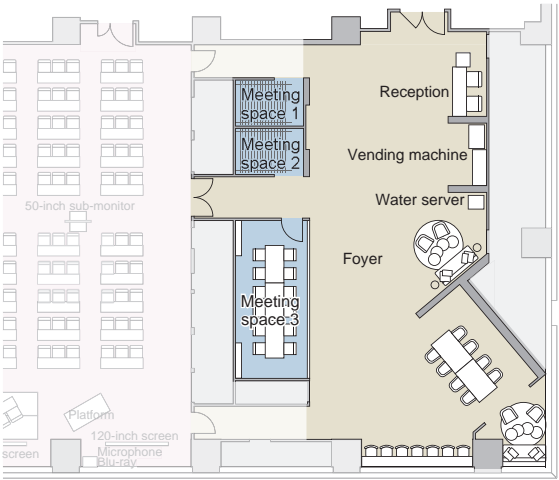

Members using the conference room can reserve the lounge for exclusive use.



Foyer

## GLOBAL LIFESCIENCE HUB

7F Nihonbashi Muromachi Mitsui Tower 3-2-1, Nihonbashi-muromachi, Chuo-ku, Tokyo

The GLOBAL LIFESCIENCE HUB is a life science innovation hub where figures from the worlds of academia and venture capital from both Japan and abroad come together. The communication lounge provides a place for lively communication and the accumulation of the latest cutting-edge knowledge.

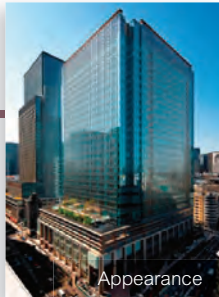

Appearance

**7F** 166.37 m<sup>2</sup> (about 50.32 tsubo)

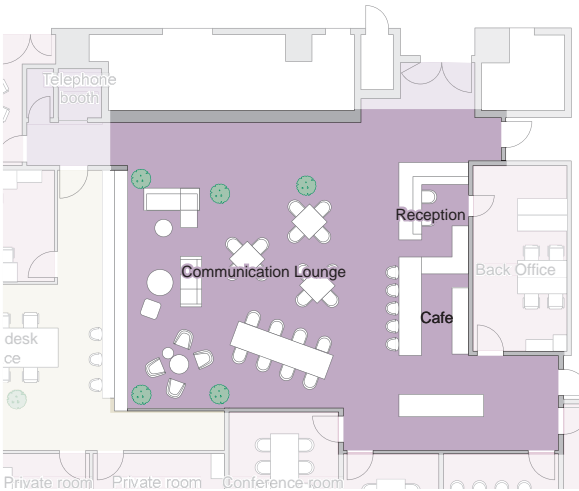

The communication lounge has an open ceiling, which gives it an open feel.



Communication lounge (7F)



# Communication Lounge

## Nihonbashi Life Science Building 3

3-8-3, Nihonbashi-honcho,  
Chuo-ku, Tokyo

Panoramic glass windows give the  
Tosho Building's communication  
lounge an open feel.

**8F** 93.29 m² (about 28.22 tsubo)

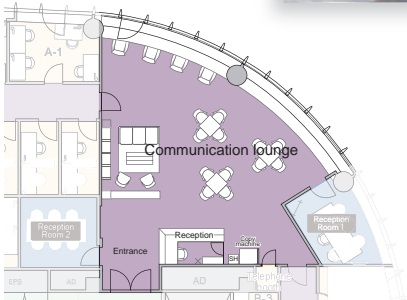

Communication lounge (8F)

## Nihonbashi Life Science Building 7

1-9-10, Nihonbashi-horidomecho,  
Chuo-ku, Tokyo

The spacious communication lounge  
can be used for refreshments and  
small meetings.

**8F** 68.23 m² (about 20.63 tsubo)

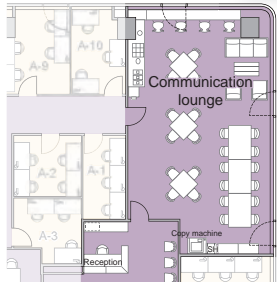

Communication lounge (8F)

## Lifescience HUB West

4F Midosuji Mitsui Building 4-1-3, Bingomachi, Chuo-ku, Osaka-shi, Osaka

The communication lounge is a wide space filled with playful design elements.  
There is also a projector space which can be used for events, etc.

**4F** 180.00 m² (about 54.45 tsubo)

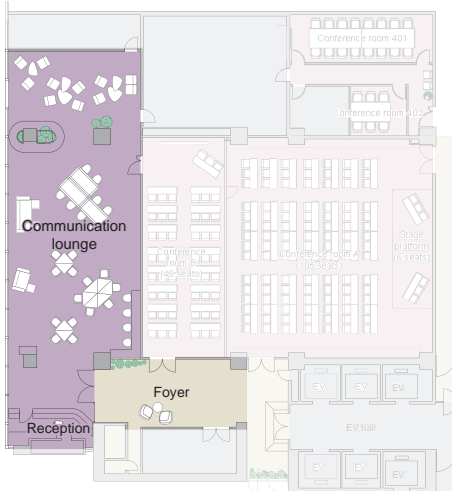

The spacious and open-feeling communication lounge



Communication lounge (4F)

### <User Guidelines>

All LINK-J members can use the communication lounges freely. Lounges that can be reserved for exclusive use can be reserved used by submitting an application in accordance with the <Reservation Guidelines> provided below.

| Building name                      | Day of Use | Operation Time                                                                   | Area m²/ (tsubo)              | Staffed Reception | Reservation Possible |
|------------------------------------|------------|----------------------------------------------------------------------------------|-------------------------------|-------------------|----------------------|
| Nihonbashi Life Science Building   | 1F         | Every day excluding end-of-year and New Year holidays and maintenance days, etc. | 66.4 m² (about 20.08 tsubo)   |                   |                      |
| Nihonbashi Life Science HUB        | 10F        |                                                                                  | 191.18 m² (about 57.82 tsubo) |                   | ○ *1                 |
| GLOBAL LIFESCIENCE HUB             |            |                                                                                  | 153.40 m² (about 46.40 tsubo) | ○                 | ○ *2                 |
| Nihonbashi Life Science Building 3 |            |                                                                                  | 166.37 m² (about 50.32 tsubo) | ○                 | ○ *3                 |
| Nihonbashi Life Science Building 7 |            |                                                                                  | 93.29 m² (about 28.22 tsubo)  | ○                 |                      |
| Lifescience HUB West               |            | Weekdays: 09:00-20:00<br>Saturdays, Sundays and public holidays: 09:00-18:30     | 68.23 m² (about 20.63 tsubo)  | ○                 |                      |
|                                    |            |                                                                                  | 180.00 m² (about 54.45 tsubo) | ○                 | ○ *4                 |

\*1 Areas that can be reserved for exclusive use are the communication lounge and a portion of the lobby area.  
\*2 Reservation for exclusive use is only possible when using all conference rooms.  
\*3 Reservations for exclusive use can only be made by GLOBAL LIFESCIENCE HUB tenants.  
\*4 Reservations for exclusive use can only be made when using Conference room A + B from 16:30 onward.

### <Reservation Guidelines>

The communication lounges of the Nihonbashi Life Science Building, Nihonbashi Life Science HUB, GLOBAL LIFESCIENCE HUB and Lifescience HUB West can be reserved for exclusive use. Please make use of them for social gatherings and parties after events. We can arrange catering services, so please feel free to ask us.

#### ■ Nihonbashi Life Science Building

| Room name                   | Area m² / ( tsubo)               | Fee [excluding tax] (yen)/hour |                      |
|-----------------------------|----------------------------------|--------------------------------|----------------------|
|                             |                                  | Special Membership A           | Special Membership B |
| 10F Communication lounge *5 | 191.18 m² (about 57.82 tsubo) *6 | 30,000 yen                     | 15,000 yen           |

\*5 The lounge is a space for use by LINK-J members only, except when it is reserved for exclusive use.  
\*6 Areas that can be reserved for exclusive use are the communication lounge and a portion of the lobby area.

#### ■ Nihonbashi Life Science HUB

| Room name | Area m² / ( tsubo)            | Fee [excluding tax] (yen)/hour |                      |
|-----------|-------------------------------|--------------------------------|----------------------|
|           |                               | Special Membership A           | Special Membership B |
| 8F Foyer  | 153.40 m² (about 46.40 tsubo) | —                              | —                    |

\* Available for exclusive use only when Conference room E (A+B+C) is used. The fee for the foyer is included in the fee for Conference room E.  
\* Reservations for the preparatory meeting space are not accepted. Please do not use this space for extended periods except when using Conference Room E.

#### ■ GLOBAL LIFESCIENCE HUB

| Room name               | Area m² / ( tsubo)            | Fee [excluding tax] (yen)/hour |
|-------------------------|-------------------------------|--------------------------------|
| 7F Communication lounge | 166.37 m² (about 50.32 tsubo) | 40,000 yen                     |

\* Reservations for exclusive use can only be made by GLOBAL LIFESCIENCE HUB tenants.

#### ■ Lifescience HUB West

| Room name               | Area m² / ( tsubo)            | Fee [excluding tax] (yen)/hour |                      |
|-------------------------|-------------------------------|--------------------------------|----------------------|
|                         |                               | Special Membership A           | Special Membership B |
| 4F Communication lounge | 180.00 m² (about 54.45 tsubo) | —                              | —                    |

\* Reservations for exclusive use can only be made when using Conference room A + B from 16:30 onward. The fee for the communication lounge is included in the fee for the conference rooms.



Conference Room

Nihonbashi Life Science Building

2-3-11, Nihonbashi-honcho, Chuo-ku, Tokyo

The Nihonbashi Life Science Building has 14 conference rooms in a variety of sizes both small and large, suitable for holding meetings with small numbers of people up to events with around 150 participants.



Appearance

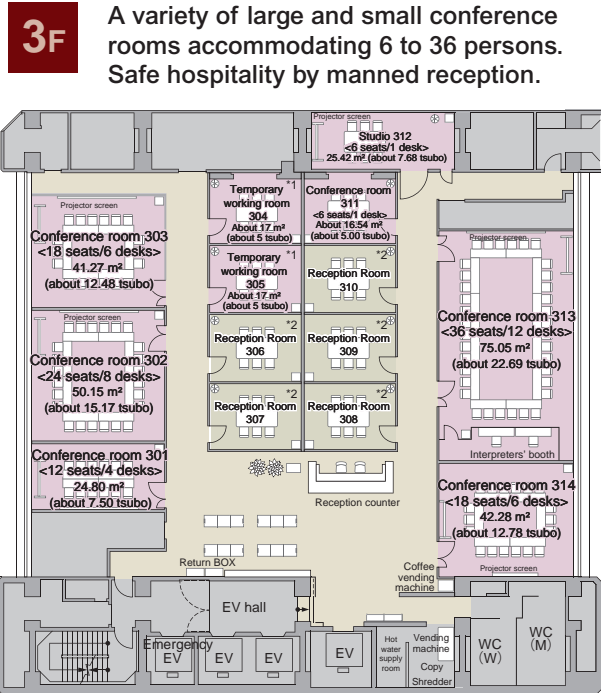
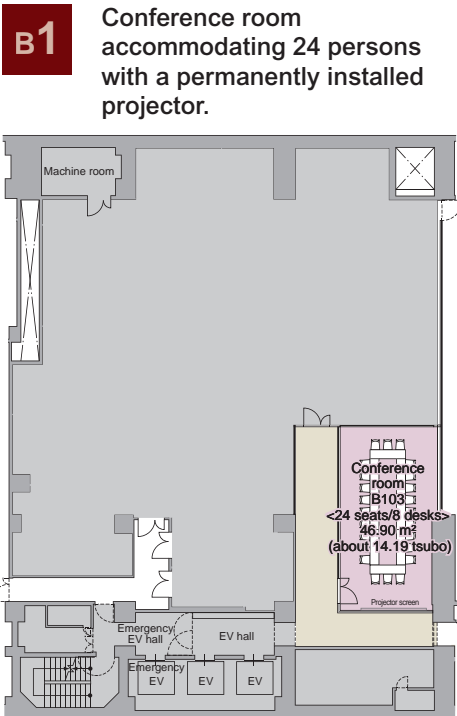
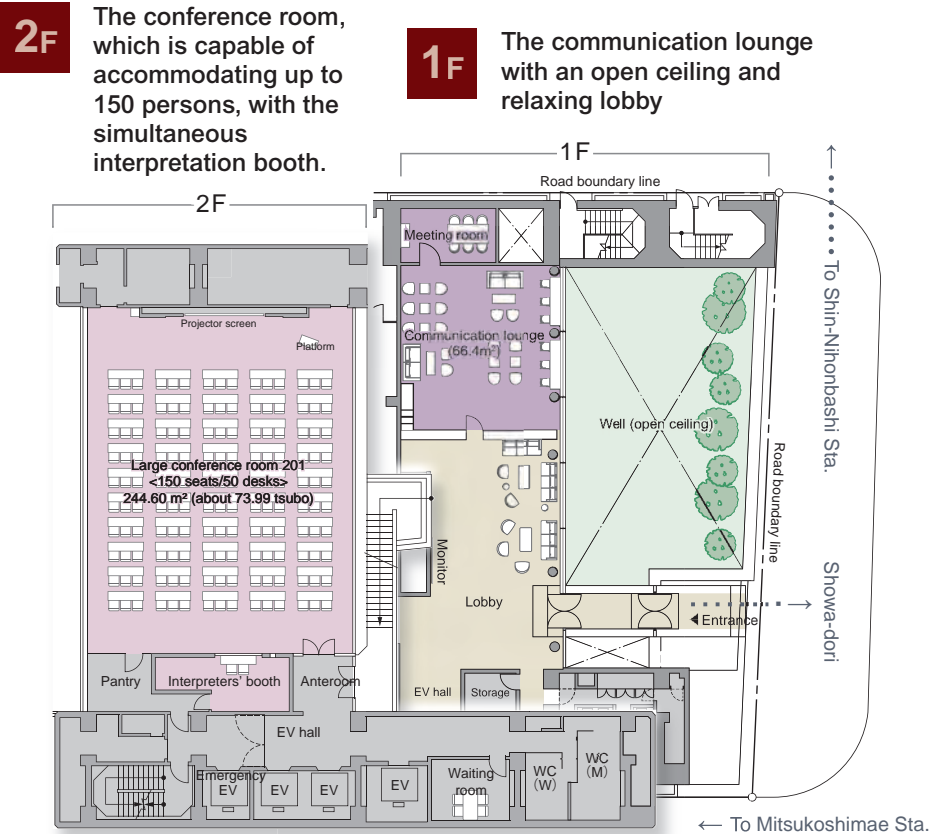

| (Excluding tax, yen/hour)                                                                                                                           | Special Membership A | Special Membership B |
|-----------------------------------------------------------------------------------------------------------------------------------------------------|----------------------|----------------------|
| ■ Conference room B103                                                                                                                              | 5,000 yen            | 2,500 yen            |
| ■ Large conference room 201                                                                                                                         | 45,000 yen           | 22,500 yen           |
| ■ Conference room 301                                                                                                                               | 3,500 yen            | 1,750 yen            |
| ■ Conference room 302                                                                                                                               | 5,000 yen            | 2,500 yen            |
| ■ Conference room 303                                                                                                                               | 4,000 yen            | 2,000 yen            |
| ■ Conference room 311                                                                                                                               | 3,000 yen            | 1,500 yen            |
| ■ Studio 312                                                                                                                                        | 3,000 yen            | 1,500 yen            |
| ■ Conference room 313                                                                                                                               | 7,000 yen            | 3,500 yen            |
| ■ Conference room 314                                                                                                                               | 4,000 yen            | 2,000 yen            |
| ■ Conference room 1004                                                                                                                              | 15,000 yen           | 7,500 yen            |
| ■ Conference room 1006                                                                                                                              | 7,000 yen            | 3,500 yen            |
| ■ Conference room 1007                                                                                                                              | 4,000 yen            | 2,000 yen            |
| ■ Conference room 1006+1007                                                                                                                         | 11,000 yen           | 5,500 yen            |
| *An hourly charge for the room will be charged as an extra charge for any change from this layout. Please refer to the user guidelines for details. |                      |                      |
| (Excluding tax, yen/day)                                                                                                                            | Special Membership A | Special Membership B |
| ■ Temporary working rooms 304/305                                                                                                                   | 20,000 yen           | 10,000 yen           |

\*1/The conference room for extended use, which can be used for up to 7 days on  
\*2/Available only to persons residing in the Nihonbashi Life Science Building.

**10F** The 10th floor has conference rooms that can be used according to numbers of participants and purpose of use.

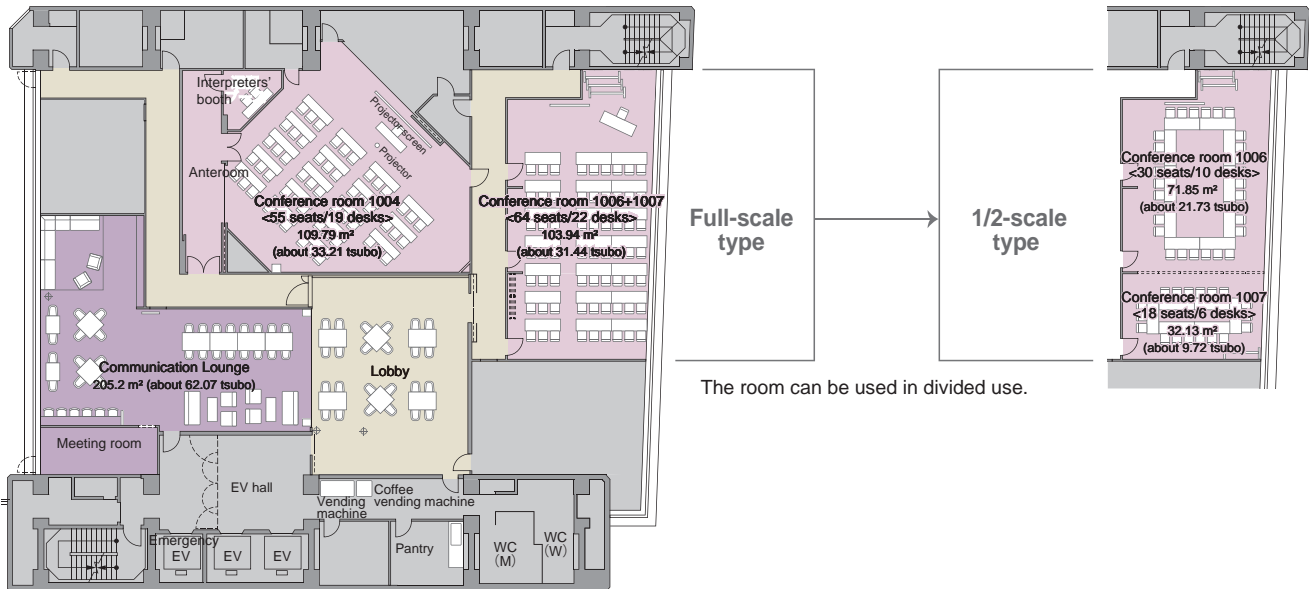

Large conference room 201



Conference room 1004

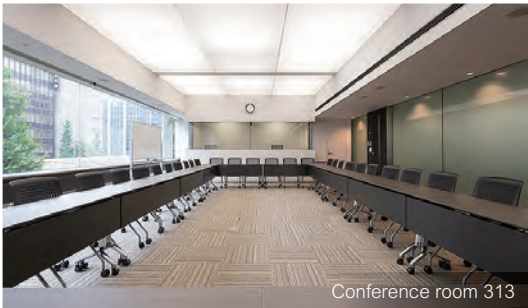

Conference room 313



Conference Room

Nihonbashi Life Science HUB

8F Muromachi Chibagin Mitsui Building 1-5-5, Nihonbashi-muromachi, Chuo-ku, Tokyo

Nihonbashi Life Science HUB has good access with a direct connection to Mitsukoshimae Station, and reliable hospitality with a staffed reception.

The conference room can accommodate up to 300 persons, making it ideal for symposiums and other large-scale events.

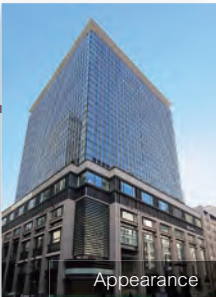

Standard classroom type plan

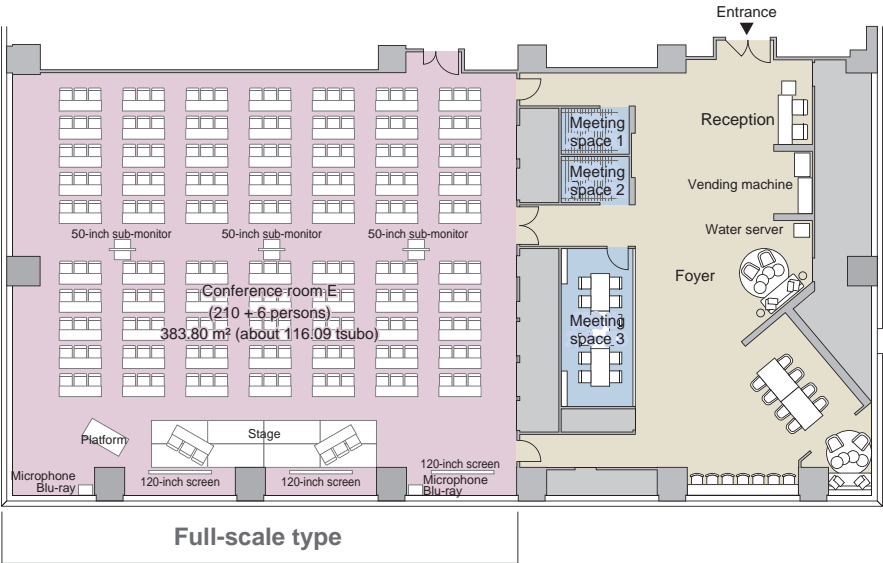

The room can be used in divided use.

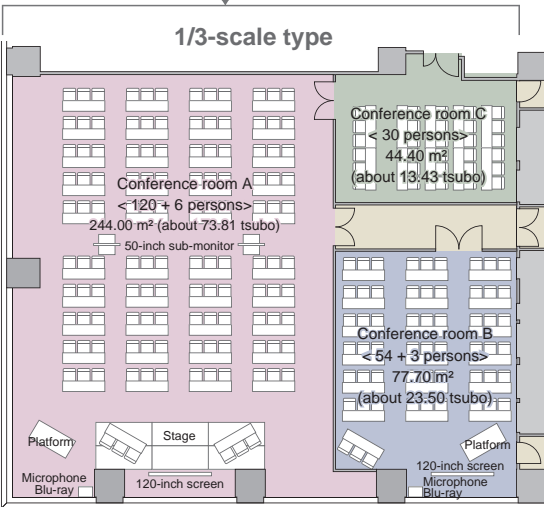
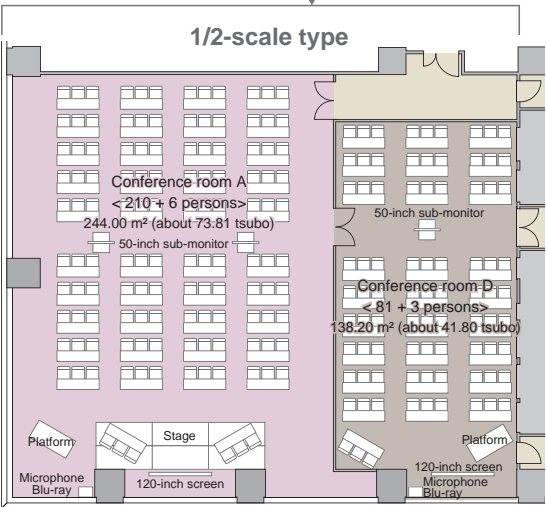

The first floor entrance is closed after 19:00 on weekdays, and on Saturdays, Sundays and holidays. You can enter via basement level B1 using the numeric keypad.



| (Excluding tax, yen/hour)                     | Special Membership A | Special Membership B |
|-----------------------------------------------|----------------------|----------------------|
| ■ Full-scale plan <Conference Room E> (A+B+C) | 77,000 yen           | 38,500 yen           |
| ■ 1/2-scale plan <Conference room A>          | 49,000 yen           | 24,500 yen           |
| ■ 1/2-scale plan <Conference room D> (B+C)    | 28,000 yen           | 14,000 yen           |
| ■ 1/3-scale plan <Conference room B>          | 17,000 yen           | 8,500 yen            |
| ■ 1/3-scale plan <Conference room C>          | 11,000 yen           | 5,500 yen            |

GLOBAL LIFESCIENCE HUB

7F Nihonbashi Muromachi Mitsui Tower 3-2-1, Nihonbashi-muromachi, Chuo-ku, Tokyo

The GLOBAL LIFESCIENCE HUB has a spacious seating layout, enabling use for a diverse range of business situations, from internal meetings to holding seminars.

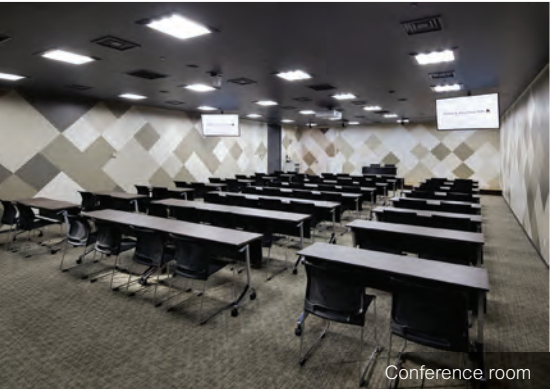

| (Excluding tax, yen/hour) | Special Membership A | Special Membership B |
|---------------------------|----------------------|----------------------|
| ■ Conference room         | 28,000 yen           | 14,000 yen           |

School type standard plan



The space can be used in various layouts according to the purpose of use.

C-shape + school type layout  
(60 persons)

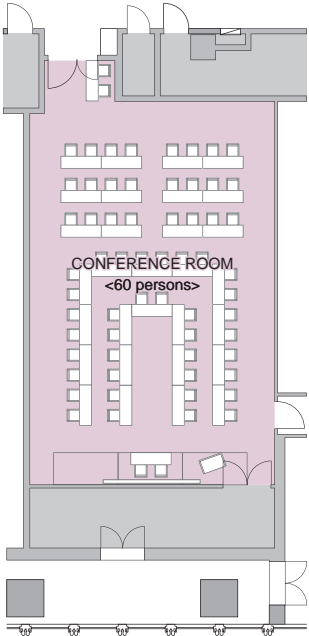

School + theater type layout  
(84 persons)



Group layout  
(54 persons)

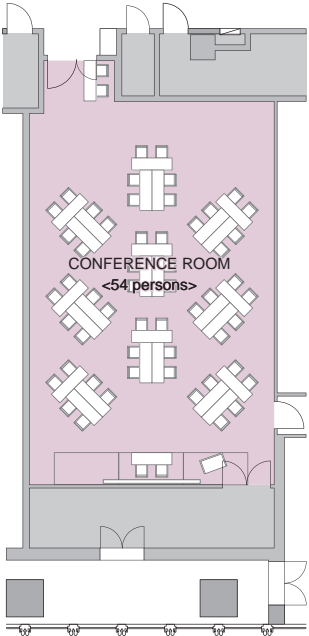



# Conference Room

## Nihonbashi Life Science Building 2

3-11-5, Nihonbashi-honcho, Chuo-ku, Tokyo

Nihonbashi Life Science Building 2 has a variety of large and small conference rooms accommodating 4 to 24 persons, with permanently installed monitors, projector screens and white boards.



Appearance

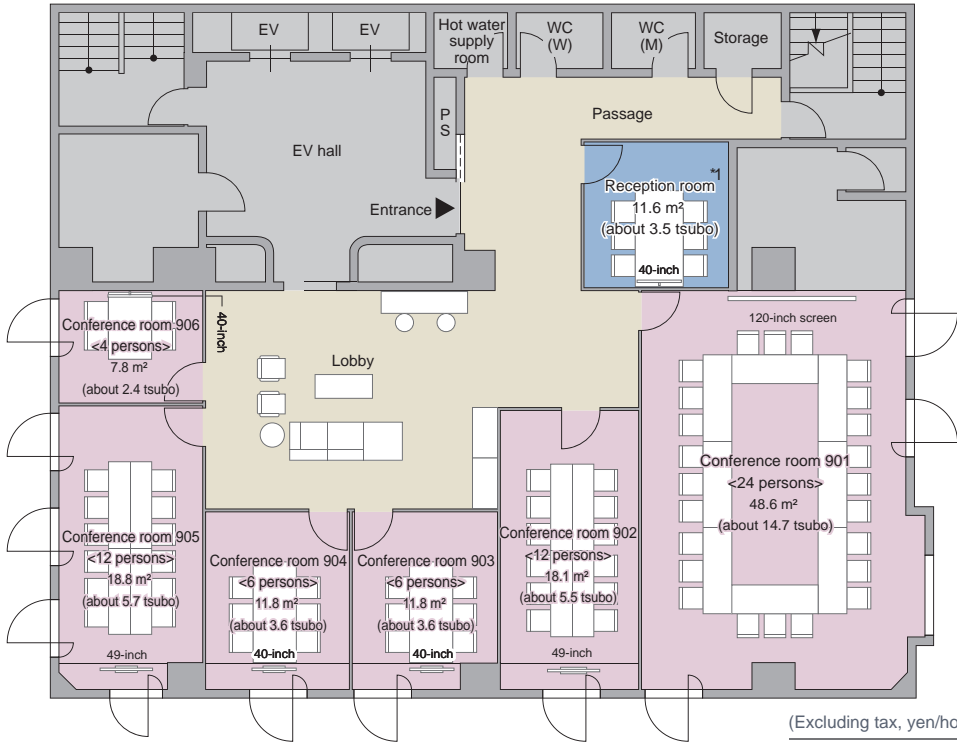

\*1/Available only to the residents of Nihonbashi Life Science Building 2.

| (Excluding tax, yen/hour) | Special Membership A | Special Membership B |
|---------------------------|----------------------|----------------------|
| ■ Conference room 901     | 5,000 yen            | 2,500 yen            |
| ■ Conference room 902     | 3,500 yen            | 1,750 yen            |
| ■ Conference room 903     | 3,000 yen            | 1,500 yen            |
| ■ Conference room 904     | 3,000 yen            | 1,500 yen            |
| ■ Conference room 905     | 3,500 yen            | 1,750 yen            |
| ■ Conference room 906     | 2,000 yen            | 1,000 yen            |



Conference room 901



Conference room 905

## Lifescience HUB West

4F Midosuji Mitsui Building 4-1-3, Bingomachi, Chuo-ku, Osaka-shi, Osaka

Lifescience HUB West is a life sciences business hub located in Osaka. The building offers a variety of large and small conference rooms accommodating 6 to 153 persons. It has also introduced a video conference system that links it to other life science business hubs in Tokyo, enabling the holding of interactive events.



Appearance

School type standard plan

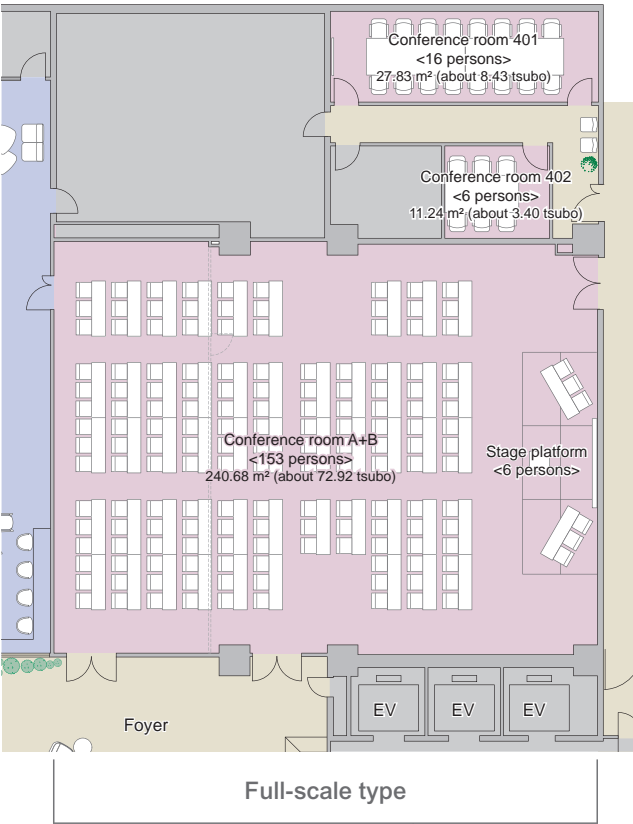

Conference room



Video conference system (only available for events hosted by LINK-J)  
The system enables streaming of events taking place at other venues, and broadcasting of events held at Lifescience HUB West to other business hubs.

|                           | Conference room      | Communication lounge |
|---------------------------|----------------------|----------------------|
| (Excluding tax, yen/hour) | Special Membership A | Special Membership B |
| ■ Conference room A       | 20,000 yen           | 10,000 yen           |
| ■ Conference room B       | 10,000 yen           | 5,000 yen            |
| ■ Conference room A+B     | 30,000 yen           | 15,000 yen           |
| ■ Conference room 401     | 3,000 yen            | 1,500 yen            |
| ■ Conference room 402     | 2,000 yen            | 1,000 yen            |

The space can be used in various layouts according to the purpose of use.

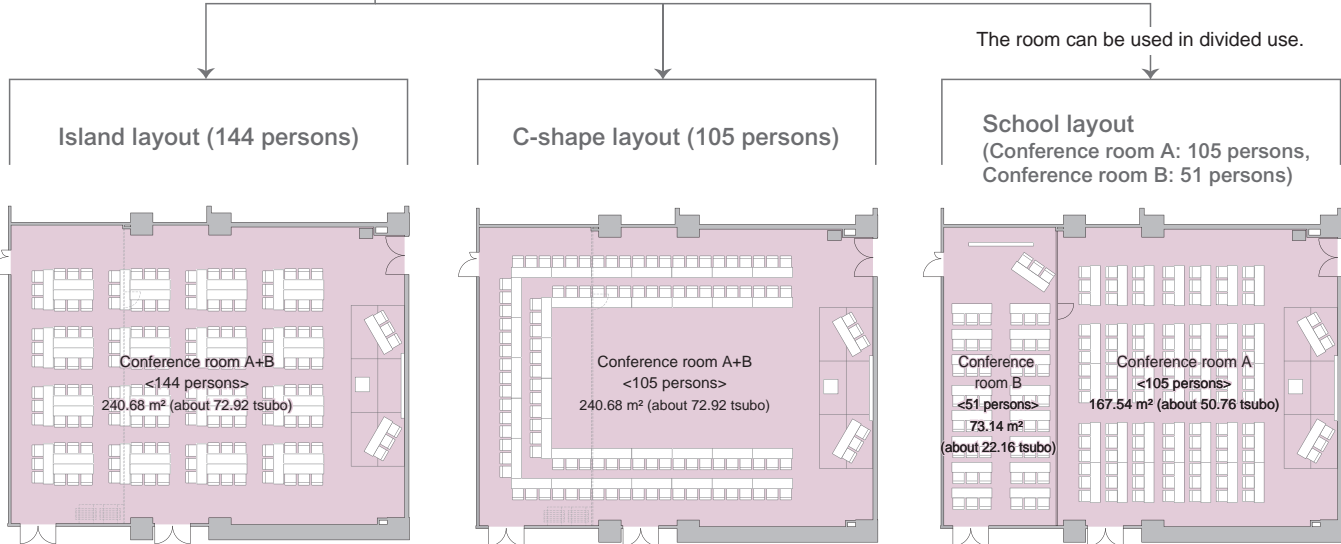



# Conference Room User Guidelines

## User Guidelines

### Day of Use

Every day (excluding end-of-year and New Year holidays, maintenance days, and other days when the building is closed)  
\* Nihonbashi Life Science Building 2 conference rooms are available for use only on weekdays.

### Operation Time

From 9:00-21:00  
\* From 9:00-17:00 only for Conference Room 1004 of the Nihonbashi Life Science Building  
\* Lifescience HUB West  
Weekdays: 9:00-20:00, Saturdays, Sundays and public holidays: 9:00-18:30

### Receipt of Application

<Nihonbashi Life Science Building, Nihonbashi Life Science HUB>  
◎ From the day one year prior to the day of use to two days prior to the day of use  
  
<Nihonbashi Life Science Building 2>  
◎ From the day one year prior to the day of use to the day of use  
  
<GLOBAL LIFESCIENCE HUB>  
◎ From two months prior to the day of use to two days prior to the day of use  
  
<Lifescience HUB West>  
◎ From the day one year prior to the day of use to two days prior to the day of use

### Cancellation of Reservation

If a reservation is to be cancelled for the customer's convenience, the following cancellation fee will be applied, with the day of use as the initial day.

- ◎ From 30 days to 15 days prior to the day of use: 50% of the original fee to be charged
- ◎ From 14 days prior to the day of use to the day of use: 100% of the original fee to be charged

\* Please refer to the user guidelines for details. Operating methods may be subject to change in the future.

### Available for parties.

We can arrange catering services, so please feel free to ask us.

## Flow of Use

A separate application for LINK-J membership will be necessary.

The use of each facility is limited to "use for the purposes of the development of the life science industry in a broad sense." Only applications from members with Special Membership A or B will be accepted. As a general rule, the use of the facilities is limited to conferences and seminars hosted or co-hosted by the special member him or herself.

Use the reservation system for reservations for this conference room.

Nihonbashi Life Science Building, Nihonbashi Life Science HUB, GLOBAL LIFESCIENCE HUB, Lifescience HUB West

Reservations are made by using the dedicated reservation system.

1 Present the reservation system registration application form to Nihonbashi Life Science HUB (e-mails accepted).

\* The users are limited to corporations, and applications for use by individual persons will not be accepted.

2 Reception of Registration for Use of Conference Room

- Your ID and password are issued after registration procedures are done by the facility staff.
- Please verify the reservation state on the dedicated page notified when the ID and the password are issued, and then make a reservation for the conference room.

3 Reservation for Conference Room

- Please verify the reservation state on the dedicated page, and then make a reservation for the conference room.

4 On the Day of Use

- On the day of use, please come directly to the reserved conference room.

\* If you would like a preview of the room or instructions on the use of the equipment, consult our reception in advance.

Nihonbashi Life Science Building 2

Make a reservation by using the dedicated reservation system "Smart Kaigisitsu."

1 Please apply in advance for the registration of your account on the dedicated page.

2 Reservation for Conference Room

- Please verify the reservation state on the dedicated page, and then make a reservation for the conference room.

3 On the Day of Use

- On the day of use, operate your mobile phone in front of the door to the conference room to unlock the door.
- The electronic lock installed in the door will react, and the door will be unlocked.

### Smart Kaigisitsu

The reservation procedure for reserving these conference rooms is different from the procedure for reserving the conference rooms at other life science hubs.

Please inquire for details of how to use the reservation system. Operate your mobile phone in front of the door to unlock the door.



## List of equipment available in conference rooms

Please refer to the user guidelines for details.

### Nihonbashi Life Science Building

| Name of equipment                                               | Conference room and quantity                                                         | Additional rental fee |
|-----------------------------------------------------------------|--------------------------------------------------------------------------------------|-----------------------|
| Desk                                                            | All rooms (the standard equipment is as shown in the drawing on the left)            | 400 yen/piece         |
| Chair                                                           | All rooms (the standard equipment is as shown in the drawing on the left)            | 200 yen/piece         |
| White board                                                     | All rooms/1 piece for each                                                           | 1,000 yen/piece       |
| Projector                                                       | 201/1004/10F lounge/1 piece for each                                                 | 10,000 yen/piece      |
| Pointer                                                         | —                                                                                    | 500 yen/piece         |
| Screen (floor-stand type)                                       | The standard equipment is available for all rooms/ 1 pieces for each (excluding 311) | 5,000 yen/piece       |
| Video conference system (the projector is available separately) | —                                                                                    | 30,000 yen/piece      |
| Wireless microphone                                             | 201/1004/4 pieces for each 10F lounge/2 pieces                                       | —                     |
| Wired microphone                                                | 201/4 pieces, 1004/2 pieces                                                          | —                     |
| Pin microphone                                                  | 10F lounge/201/1004/2 pieces for each                                                | —                     |
| Platform                                                        | 201/2 pieces                                                                         | —                     |
| Platform                                                        | 201/2 pieces                                                                         | —                     |
| Wired LAN                                                       | 1 line for each (2 lines for 201/1004) (311, B103/none)                              | —                     |
| Wireless LAN                                                    | All rooms                                                                            | —                     |
| Sign stand                                                      | —                                                                                    | 1,000 yen/piece       |
| Microphone stand (desktop type/floor-stand type)                | 201/2 pieces 10F lounge/1 piece                                                      | —                     |

### Nihonbashi Life Science HUB

| Name of equipment                                | Quantity          | Remarks                                  |
|--------------------------------------------------|-------------------|------------------------------------------|
| Desk                                             | 81 pieces         |                                          |
| Chair                                            | 300 pieces        |                                          |
| Stage                                            | 8 pieces          | A/6 pieces E/8 pieces                    |
| White board                                      | 3 pieces          | A/B/C/1 piece for each                   |
| Projector                                        | 3 pieces          |                                          |
| Pointer                                          | 2 pieces          |                                          |
| Screen                                           | 3 screens         |                                          |
| Sub-display                                      | 3 pieces          |                                          |
| Wireless microphone                              | 8 pieces          | A/5 pieces B/D/3 pieces E/8 pieces       |
| Blu-ray player                                   | 2 pieces          | A/B/D/1 piece each E/2 pieces            |
| Wireless LAN                                     | Built-in          |                                          |
| Microphone stand (desktop type/floor-stand type) | 2 pieces for each | A/B/D/1 piece each E/2 pieces            |
| Platform                                         | 2 pieces          | A/B/D/1 piece each E/2 pieces            |
| Video conference system                          | 1 piece           | E or A Additional rental fee: 30,000 yen |

### GLOBAL LIFESCIENCE HUB

| Name of equipment                                | Quantity          | Remarks                           |
|--------------------------------------------------|-------------------|-----------------------------------|
| Desk                                             | 37 pieces         | Seats 2 persons                   |
| Chair                                            | 114 pieces        |                                   |
| Stage                                            | 3 pieces          |                                   |
| White board                                      | 10 pieces         | Size: W880xH1863 mm               |
| Projector                                        | 1 piece           |                                   |
| Pointer                                          | 1 piece           |                                   |
| Screen                                           | 1 screen          |                                   |
| Sub-display                                      | 2 pieces          |                                   |
| Wireless microphone                              | 3 pieces          | Of which one is a pin microphone  |
| Wired microphone                                 | 1 piece           |                                   |
| Microphone stand (desktop type/floor-stand type) | 2 pieces for each |                                   |
| Platform                                         | 1 piece           |                                   |
| Wireless LAN                                     | Built-in          |                                   |
| Wired LAN                                        | 2 pieces          |                                   |
| Sign stand                                       | 4 pieces          |                                   |
| Video conference system                          | 1 piece           | Additional rental fee: 30,000 yen |

### Nihonbashi Life Science Building 2

| Name of equipment   | Conference room     | Remarks                  |
|---------------------|---------------------|--------------------------|
| Monitor             | 902/903/904/905/906 | 40-inch or 49-inch       |
| HDMI/VGA connection | All rooms           | —                        |
| Screen              | 901                 | 267 × 150 cm (49 inches) |
| Projector           | 901                 | 3,300 1 m                |
| White board         | All rooms           | Wall-integrated type     |
| Clock               | All rooms           | —                        |

### Lifescience HUB West

| Name of equipment          | Quantity   | Additional rental fee | Remarks                            |
|----------------------------|------------|-----------------------|------------------------------------|
| Desk                       | 59 pieces  | 400 yen               |                                    |
| Chair                      | 215 pieces | 200 yen               |                                    |
| Stage                      | 6 pieces   |                       | A only                             |
| White board                | 2 pieces   | 1,000 yen             | Other vertical type 10             |
| Projector                  | 2 pieces   | 10,000 yen            |                                    |
| Pointer                    | 3 pieces   | 500 yen               |                                    |
| Sign stand                 | 5 pieces   | 1,000 yen             | For posting notices in shared area |
| IR wireless mic (handheld) | 5 pieces   |                       |                                    |
| Wired microphone           | 2 pieces   |                       |                                    |
| IR wireless mic (pin type) | 2 pieces   |                       |                                    |
| Platform                   | 1 piece    |                       | A/B                                |
| Wired LAN                  | 3 pieces   |                       | A: 2 lines B: 1 line               |
| Wireless LAN               | Built-in   |                       |                                    |
| Video conference system    | 1 piece    | 30,000 yen            | A only                             |



# List of Conference Room Fees

## Nihonbashi Life Science Building

| Room name                                  | Area<br>m <sup>2</sup> / (tsubo)          | Capacity (number of persons) |                                      |                              |                              | Fee [excluding tax] (yen)/hour |                         |
|--------------------------------------------|-------------------------------------------|------------------------------|--------------------------------------|------------------------------|------------------------------|--------------------------------|-------------------------|
|                                            |                                           | School<br>type 1             | School<br>type 2 <sup>*1&amp;2</sup> | Island<br>type <sup>*1</sup> | Square<br>type <sup>*1</sup> | Special<br>Membership A        | Special<br>Membership B |
| B1 Conference room B103                    | 47.10 m <sup>2</sup> (about 14.24 tsubo)  | 24 persons                   | —                                    | 18 persons                   | 24 persons                   | 5,000 yen                      | 2,500 yen               |
| 2F Large conference room 201 <sup>*3</sup> | 244.60 m <sup>2</sup> (about 73.99 tsubo) | 150 persons                  | —                                    | 144 persons                  | 90 persons <sup>*4</sup>     | 45,000 yen                     | 22,500 yen              |
| Conference room 301                        | 24.80 m <sup>2</sup> (about 7.50 tsubo)   | 12 persons                   | —                                    | 12 persons                   | 12 persons                   | 3,500 yen                      | 1,750 yen               |
| Conference room 302                        | 50.15 m <sup>2</sup> (about 15.17 tsubo)  | 24 persons                   | —                                    | 18 persons                   | 24 persons                   | 5,000 yen                      | 2,500 yen               |
| Conference room 303                        | 41.27 m <sup>2</sup> (about 12.48 tsubo)  | 18 persons                   | —                                    | 18 persons                   | 18 persons                   | 4,000 yen                      | 2,000 yen               |
| 3F Conference room 311                     | 16.54 m <sup>2</sup> (about 5.00 tsubo)   | —                            | —                                    | 6 persons                    | —                            | 3,000 yen                      | 1,500 yen               |
| Studio 312 (Soundproofing specifications)  | 25.42 m <sup>2</sup> (about 7.68 tsubo)   | —                            | —                                    | 6 persons                    | —                            | 3,000 yen                      | 1,500 yen               |
| Conference room 313 <sup>*3</sup>          | 75.05 m <sup>2</sup> (about 22.69 tsubo)  | 36 persons                   | —                                    | 27 persons                   | 36 persons                   | 7,000 yen                      | 3,500 yen               |
| Conference room 314                        | 42.28 m <sup>2</sup> (about 12.78 tsubo)  | 18 persons                   | —                                    | 18 persons                   | 18 persons                   | 4,000 yen                      | 2,000 yen               |
| 10F Conference room 1004 <sup>*3</sup>     | 109.79m <sup>2</sup> (about 33.21 tsubo)  | 55 persons                   | —                                    | 46 persons                   | 36 persons                   | 15,000 yen                     | 7,500 yen               |
| Conference room 1006                       | 71.85m <sup>2</sup> (about 21.73 tsubo)   | 36 persons                   | 27 persons                           | —                            | 30 persons                   | 7,000 yen                      | 3,500 yen               |
| Conference room 1007                       | 32.13m <sup>2</sup> (about 9.72 tsubo)    | 15 persons                   | 15 persons                           | —                            | 18 persons                   | 4,000 yen                      | 2,000 yen               |
| Conference room 1006 +1007                 | 103.94m <sup>2</sup> (about 31.44 tsubo)  | 63 persons                   | 42 persons                           | 66 persons                   | 42 persons                   | 11,000 yen                     | 5,500 yen               |

## Nihonbashi Life Science HUB

| Room name                                      | Area<br>m <sup>2</sup> / (tsubo)           | Capacity (number of persons) |                              |                              |                              | Fee [excluding tax] (yen)/hour |                         |
|------------------------------------------------|--------------------------------------------|------------------------------|------------------------------|------------------------------|------------------------------|--------------------------------|-------------------------|
|                                                |                                            | School<br>type               | School<br>type <sup>*1</sup> | Island<br>type <sup>*1</sup> | Square<br>type <sup>*1</sup> | Special<br>Membership A        | Special<br>Membership B |
| Conference room A                              | 244.00 m <sup>2</sup> (about 73.81 tsubo)  | 120 persons                  | 180 persons                  | 102 persons <sup>*3</sup>    | Negotiable                   | 49,000 yen                     | 24,500 yen              |
| Conference room B                              | 77.70 m <sup>2</sup> (about 23.50 tsubo)   | 54 persons                   | 70 persons                   | 36 persons                   | 54 persons                   | 17,000 yen                     | 8,500 yen               |
| Conference room C                              | 44.40 m <sup>2</sup> (about 13.43 tsubo)   | 30 persons                   | 36 persons                   | 24 persons                   | 27 persons                   | 11,000 yen                     | 11,000 yen              |
| 8F Conference room D <sup>*2</sup><br>(B + C)  | 138.20 m <sup>2</sup> (about 41.80 tsubo)  | 81 persons                   | 110 persons                  | 48 persons                   | Negotiable                   | 28,000 yen                     | 14,000 yen              |
| Conference room E <sup>*2</sup><br>(A + B + C) | 383.80 m <sup>2</sup> (about 116.09 tsubo) | 210 persons                  | 300 persons                  | 152 persons <sup>*3</sup>    | Negotiable                   | 77,000 yen                     | 38,500 yen              |

## GLOBAL LIFESCIENCE HUB

| Room name          | Area<br>m <sup>2</sup> / (tsubo)          | Capacity (number of persons) |                                           |                              |                               |                                           |                             | Fee [excluding tax] (yen)/hour |                         |
|--------------------|-------------------------------------------|------------------------------|-------------------------------------------|------------------------------|-------------------------------|-------------------------------------------|-----------------------------|--------------------------------|-------------------------|
|                    |                                           | School<br>type               | C-shape<br>+ school<br>type <sup>*1</sup> | Square<br>type <sup>*1</sup> | Theater<br>type <sup>*1</sup> | School<br>+ theater<br>type <sup>*1</sup> | Group<br>type <sup>*1</sup> | Special<br>Membership A        | Special<br>Membership B |
| 7F Conference room | 138.63 m <sup>2</sup> (about 41.93 tsubo) | 70<br>persons                | 60<br>persons                             | 32<br>persons                | 110<br>persons                | 84<br>persons                             | 54<br>persons               | 28,000 yen                     | 14,000 yen              |

## Nihonbashi Life Science Building 2

| Room name              | Area<br>m <sup>2</sup> / (tsubo)       | Capacity (number of persons) | Fee [excluding tax] (yen)/hour |                         |
|------------------------|----------------------------------------|------------------------------|--------------------------------|-------------------------|
|                        |                                        |                              | Special<br>Membership A        | Special<br>Membership B |
| 9F Conference room 901 | 48.6 m <sup>2</sup> (about 14.7 tsubo) | 24 persons                   | 5,000 yen                      | 2,500 yen               |
| Conference room 902    | 18.1 m <sup>2</sup> (about 5.5 tsubo)  | 12 persons                   | 3,500 yen                      | 1,750 yen               |
| Conference room 903    | 11.8 m <sup>2</sup> (about 3.6 tsubo)  | 6 persons                    | 3,000 yen                      | 1,500 yen               |
| Conference room 904    | 11.8 m <sup>2</sup> (about 3.6 tsubo)  | 6 persons                    | 3,000 yen                      | 1,500 yen               |
| Conference room 905    | 18.8 m <sup>2</sup> (about 5.7 tsubo)  | 12 persons                   | 3,500 yen                      | 1,750 yen               |
| Conference room 906    | 7.8 m <sup>2</sup> (about 2.4 tsubo)   | 4 persons                    | 2,000 yen                      | 1,000 yen               |

## Lifescience HUB West

| Room name                              | Area<br>m <sup>2</sup> / (tsubo)          | Capacity (number of persons) |                              |                              |                       | Fee [excluding tax] (yen)/hour |                         |
|----------------------------------------|-------------------------------------------|------------------------------|------------------------------|------------------------------|-----------------------|--------------------------------|-------------------------|
|                                        |                                           | School<br>type               | Island<br>type <sup>*1</sup> | Square<br>type <sup>*1</sup> | C-shape <sup>*1</sup> | Special<br>Membership A        | Special<br>Membership B |
| Conference room A                      | 167.54 m <sup>2</sup> (about 50.76 tsubo) | 105 persons                  | 99 persons                   | 54 persons                   | —                     | 20,000 yen                     | 10,000 yen              |
| Conference room B                      | 73.14 m <sup>2</sup> (about 22.16 tsubo)  | 51 persons                   | 54 persons                   | 36 persons                   | —                     | 10,000 yen                     | 5,000 yen               |
| 4F Conference Room A + B <sup>*2</sup> | 240.68 m <sup>2</sup> (about 72.92 tsubo) | 153 persons                  | 144 persons                  | —                            | 105 persons           | 30,000 yen                     | 15,000 yen              |
| Conference room 401                    | 27.83 m <sup>2</sup> (about 8.43 tsubo)   | —                            | 16 persons                   | —                            | —                     | 3,000 yen                      | 1,500 yen               |
| Conference room 402                    | 11.24 m <sup>2</sup> (about 3.40 tsubo)   | —                            | 6 persons                    | —                            | —                     | 2,000 yen                      | 1,500 yen               |

\*1 Because a change in the layout is necessary, the fee for one hour's use of the room will be charged separately.  
(If the layout is to be changed by the customer during the reserved hours, no extra fee for changing the layout will be charged. Please restore the layout to the original state after use.)  
\*2 When in use in long rectangular layout.  
\*3 Equipped with a simultaneous interpreters' booth  
\*4 Double reversed C-like layout

\*1 Because a change in the layout is necessary, the fee for one hour's use of the room will be charged separately.  
(If the layout is to be changed by the customer during the reserved hours, no extra fee for changing the layout will be charged. Please restore the layout to the original state after use.)  
\*2 By opening the movable partition, the conference rooms (Conference Rooms D and E) can be used jointly.  
If Conference room E (A + B + C) is used, the foyer can be used exclusively.  
\*3 Double reversed C-like layout

\*1 Because a change in the layout is necessary, the fee for one hour's use of the room will be charged separately.  
(If the layout is to be changed by the customer during the reserved hours, no extra fee for changing the layout will be charged. Please restore the layout to the original state after use.)

\* Requests for layout changes are not accepted.  
(The layout can be changed by the customer during the reserved hours. Please restore the layout to the original state after use.)

\*1 Because a change in the layout is necessary, the fee for one hour's use of the room will be charged separately.  
(If the layout is to be changed by the customer during the reserved hours, no extra fee for changing the layout will be charged. Please restore the layout to the original state after use.)  
\*2 By opening the movable partition, the conference rooms can be used jointly.

LINK-J is a platform for interaction between people involved in the life sciences.



The aim of LINK-J (Life Science Innovation Network Japan) is to build a platform for continuous creation of products and services that contribute to people's health by creating opportunities for exchanges between individuals in life science research and industry in a broad sense, in areas such as preventive and presymptomatic medicine, and health and longevity; including regenerative medicine, personalized medicine, drug discovery, medical devices and healthcare-related IT.

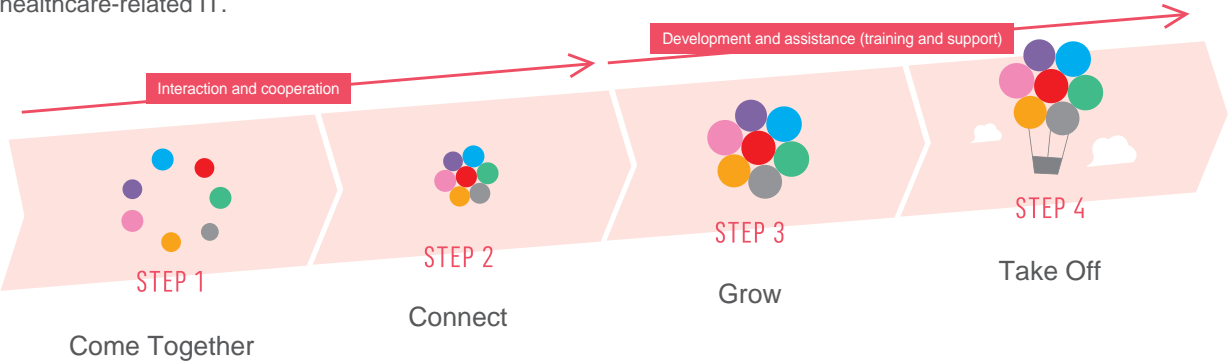

### Interaction and cooperation



Events for networking



Hosting large-scale symposiums

### Development and assistance (training and support)



Business startup support program



Support for venture companies

### The Benefits of LINK-J Special Membership

| Details of services                                                                              | Corporation | Individual |
|--------------------------------------------------------------------------------------------------|-------------|------------|
| Participation in events and programs (at Special Member price)                                   | ●           | ●          |
| Notification of events and programs (Posts on LINK-J websites and digital signage)               | ●           |            |
| Listing of information on LINK-J website (bulletin board)                                        | ●           |            |
| Listing of company / group name on LINK-J website and pamphlets, etc.                            | ●           |            |
| Interactions with and introductions to other members                                             | ●           | ●          |
| Use of members-only communication lounges (free)                                                 | ●           | ●          |
| Reserved exclusive use of communication lounges for parties, etc. (at special membership prices) | ●           |            |
| Use of conference rooms and temporary working rooms (at special membership prices)               | ●           |            |
| Use of shared offices (separate application and payment required)                                | ●           | ●          |
| Consultations and advice to LINK-J discussion supporters                                         | ●           | ●          |

\*There are three types of special membership: Special Membership A & B (Corporation) and Special Membership C (Individual). Membership requires payment of an initiation fee and annual fee.

LINK-J Special Membership (not subject to consumption tax)

<https://www.link-j.org/>

|                 |                |             |                 |                |                                                                                                                   |
|-----------------|----------------|-------------|-----------------|----------------|-------------------------------------------------------------------------------------------------------------------|
| A <sup>*1</sup> | Initiation fee | 100,000 yen | C <sup>*3</sup> | Initiation fee | 2,000 yen                                                                                                         |
|                 | Annual fee     | 500,000 yen |                 | Annual fee 1   | Doctors, corporate practitioners and employees, other individuals<br>30,000 yen                                   |
| B <sup>*2</sup> | Initiation fee | 30,000 yen  |                 | Annual fee 2   | Practitioners and employees of nonprofit organizations, etc. that fall under Special Membership B.2)<br>5,000 yen |
|                 | Annual fee     | 120,000 yen |                 | Annual fee 3   | University undergraduate and graduate students<br>3,000 yen                                                       |

\*1. Firms with more than 100 employees

\*2. 1) Firms with 100 employees or fewer  
2) Nonprofit organizations (independent administrative agencies, national research and development corporations, government agencies, educational corporations, general corporations, public-service corporations, social-welfare corporations, diplomatic missions in Japan, etc.)

\*3. Special Membership C does not include exclusive use of communication lounges, conference rooms, and temporary working rooms.



\*1. Firms with more than 100 employees  
\*2. 1) Firms with 100 employees or fewer  
2) Nonprofit organizations (independent administrative agencies, national research and development corporations, government agencies, educational corporations, general corporations, public-service corporations, social-welfare corporations, diplomatic missions in Japan, etc.)  
\*3. Special Membership C does not include exclusive use of communication lounges, conference rooms, and temporary working rooms.



### Life Science Innovation Network Japan, Inc. (LINK-J)

TEL: 03-3241-4911, FAX: 03-3241-3757 (09:00 to 17:00, Monday to Friday) www.link-j.org/en/  
2F Nihonbashi IT building, 3-3-9 Nihonbashi-muromachi, Chuo-ku, Tokyo, 103-0022